

Note. The Lots Marked A, are Regular Figures 32 by 125 feet each Containing five Acres
Ditto Marked B, are four sided Figures, most of them 40 by 20 P. each Containing five Acres
These Lots which are only Numbered are Irregular Figures Containing as follows
Acres.

19	5.0.16	78	4.2.11
20	7.0.30	99	4.3.16
21	4.0.5	96	6.0.32
28	5.1.17	104	12.3.0
35	5.1.10	105	5.2.9
43	6.0.6	100	7.3.20
50	6.3.25	107	6.1.13
53	7.0.11	101	6.1.23
58	7.2.17	101	5.3.17
59	6.1.25	103	5.0.10
60	8.0.15	105	5.0.10
66	10.0.22	117	5.0.39
67	5.3.33	124	4.2.19
68	2.2.6	102	5.2.20
69	4.0.25	121	5.2.5
70	5.1.20	121	4.2.1
71	6.2.25	122	7.3.34
72	7.3.27	125	5.0.23
73	8.1.4	110	3.1.12
74	6.2.16	107	6.0.17
76	5.0.36	110	7.0.2
77	6.3.30		

The Ground Drawn by Thomas Wilson
Mill Dam is Coloured Red and Contains Right
Acres and Fifteen perches for which he proposes to pay
at the rate of the other out Lots

- C Center of the Town of Carlisle
- G Graveyard Lot twenty five Perches

N.B The lines laid down in this Draught
represent & divide only such Lands
as were purchased of sundry persons near Carlisle
for the use of the Proprietary Family, and are
exclusive of those laid out as part of their Tenhs

(Endorsement on back)
Plan of Carlisle
&
The Lands adjacent
57

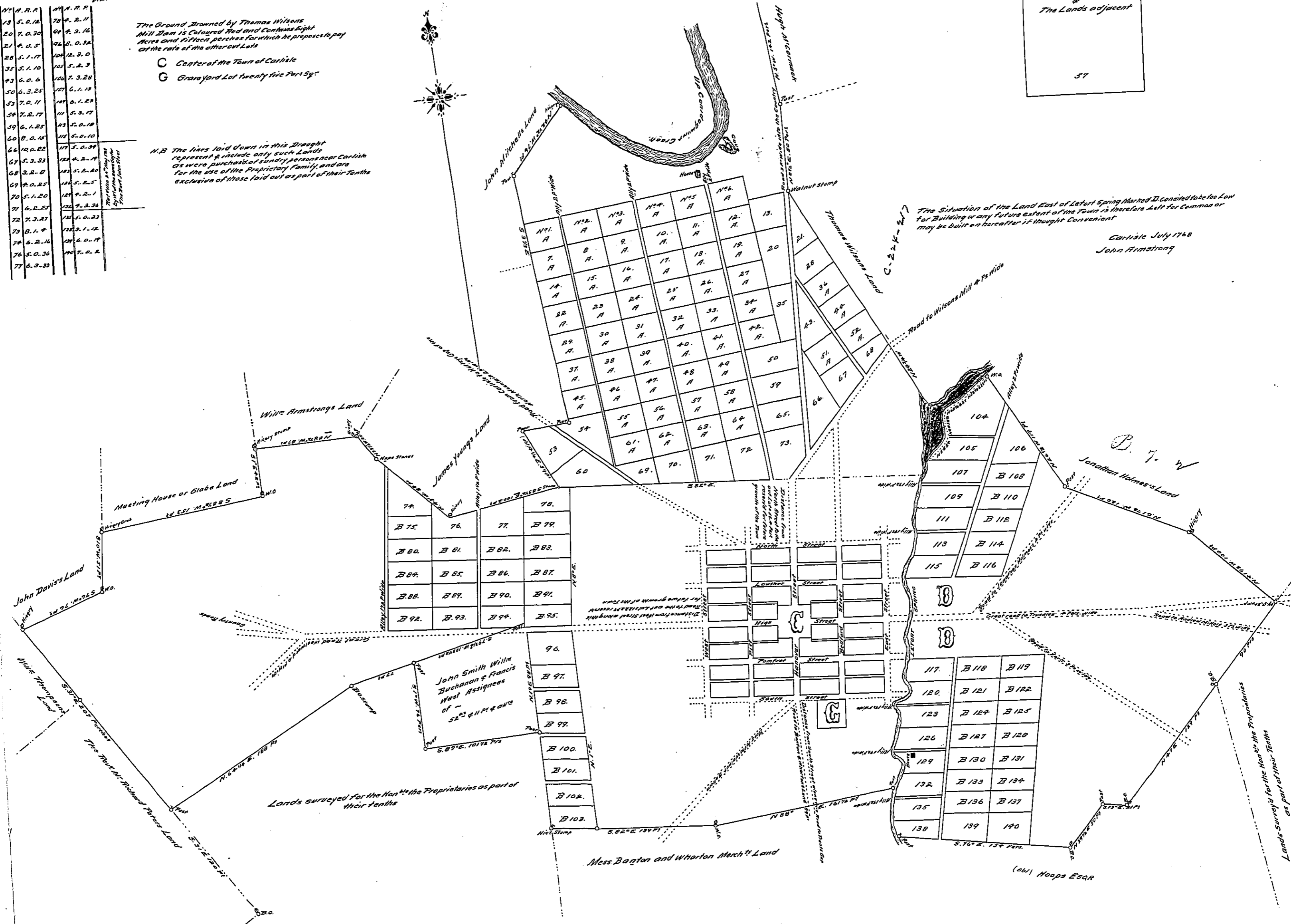

In Testimony, That the above is a copy of the Original remaining on file in the Department of Internal Affairs of Pennsylvania, made conformably
to an Act of Assembly approved the 16th day of February, 1833. I have hereunto set my Hand and caused the Seal of said Depart-
ment to be affixed at Harrisburg, the thirteenth day of October 1791.

Henry Howe
Secretary of Internal Affairs.